

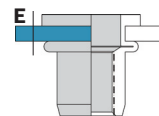

CYLINDRICAL LARGE HEAD ANCHA LISA

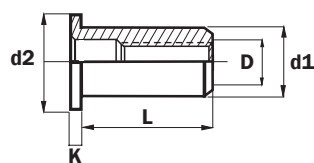

| English | Español | Français | Deutsch | Portugues |
|----------------|--------------|-------------|---------------|--------------|
| Large head | Cabeza ancha | Tête large | Flachrundkopf | Cabeça larga |
| Cylindrical | Lisa | Lisa | Rundschaft | Lisa |
| Open end | Fondo Abieto | Fond ouvert | Offen | Fundo aberto |
| Steel * | Acero * | Acier * | Stahl * | Aço * |
| Zincplated A3K | Cincado A3K | Zingué A3K | Verzinkt A3K | Zincado A3K |

* Steel /acero DIN EN 10016-

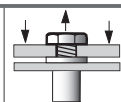
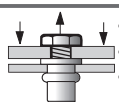
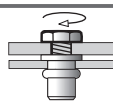

| D |  MAX. E m/m | L Nominal m/m | d1 Ø m/m | d2 Ø m/m | K m/m |  | Part No./Ref. |
|-------------|---|---------------------|----------------|----------------|----------|--|---------------|
| M 4 | 0,50 - 2,00 | 9,50 | 5,90 | 9,00 | 1,00 | 6,10 | 0301104006 |
| | 2,00 - 4,00 | 12,25 | | | | | 0301114006 |
| M 5 | 0,50 - 3,00 | 12,00 | 6,90 | 10,00 | 1,00 | 7,10 | 0301105007 |
| | 3,00 - 5,50 | 15,00 | | | | | 0301115007 |
| | 5,50 - 8,00 | 18,00 | | | | | 0301185007 |
| M 6 | 0,50 - 3,00 | 14,50 | 8,90 | 13,00 | 1,50 | 9,10 | 0301106009 |
| | 3,00 - 5,50 | 16,50 | | | | | 0301116009 |
| | 5,50 - 8,00 | 19,00 | | | | | 0301186009 |
| M 8 | 0,50 - 3,00 | 16,50 | 10,90 | 16,00 | 1,50 | 11,10 | 0301108011 |
| | 3,00 - 5,50 | 18,50 | | | | | 0301118011 |
| | 5,50 - 8,00 | 22,50 | | | | | 0301188011 |
| | 8,00 - 10,50 | 25,50 | | | | | 03011108011 |
| M 10 | 1,00 - 3,50 | 17,50 | 11,90 | 16,00 | 1,70 | 12,10 | 0301101012 |
| M 10 | 1,00 - 3,50 | 19,50 | 12,90 | 19,00 | 2,00 | 13,10 | 0301101013 |
| | 3,50 - 6,00 | 21,50 | | | | | 0301111013 |
| | 5,50 - 8,00 | 27,00 | | | | | G301181013 |
| M 12 | 1,00 - 4,00 | 25,00 | 15,90 | 23,00 | 2,00 | 16,10 | G301101216 |

| D |  Setting effort Fuerza para remachado |  Tensile Strength Threads Tracción |  Torque Testing Par de apriete |
|------------|---|--|--|
| M 4 | 4400 | 7900 | 3,0 |
| M 5 | 5300 | 9800 | 4,8 |
| M 6 | 6500 | 19100 | 12,0 |
| M 8 | 8350 | 29800 | 23,0 |
| M10 | 12000 | 34000 | 30,0 |
| M10 | 11000 | 43300 | 30,0 |
| M12 | 18000 | >57800 | 54,0 |

The total or partial reproduction of this document is prohibited. The figures showed in this catalogue are typical values and they could be changed as a result of the continuous improvement of products. Please, do not hesitate to contact us if you need an updated information.

Queda prohibida la reproducción total o parcial de este documento. Los datos que aparecen en este catálogo son valores típicos y están sujetos a modificaciones como consecuencia de la mejora continua de los productos. Consúltenos si necesita información actualizada.